

**PRESENZA**  
— ITALIA —

# DELUXE SPA SOAKING TUB



## INSTALLATION GUIDE AND USER MANUAL

Model No. QB020

## Table of Contents

Table of Contents .....	2
Safety Information .....	2
Warranty	
Five Year Limited Warranty .....	3
Warranty Claim Procedure .....	3
Pre-Installation	
Tools/Materials Required .....	4
Parts Required .....	4
Package Contents .....	5

Installation	
Installing the Leveling Legs .....	6
Installing the Drain/Overflow .....	7
Care and Cleaning .....	9
Service Parts .....	10

## Safety Information

### READ AND SAVE THESE INSTRUCTIONS



**WARNING:** Always wear safety goggles and gloves in order to avoid any personal injuries.

1. Inspect your unit before proceeding. Once you unpack your unit, check for chips, scratches, cracks, dents or scuff marks. If any damage is noticed, do not install.
2. Use this unit only in the manner intended by the manufacturer. If you have any questions, contact the manufacturer.
3. Installation work and plumbing must be done by qualified person(s) in accordance with all applicable codes and standards.
4. Protect the entire surface during installation.
5. Make sure the floor structure is capable of supporting 100 lbs (45.5 kgs) per square foot.
6. All holes drilled into the unit must be done from the finished surface side with extreme care and caulked very carefully to form a watertight barrier.

# Warranty

## FIVE YEAR LIMITED WARRANTY

A thorough inspection must be made before installation and any damage must be promptly reported. We will not be liable for failures or damage that could have been discovered or avoided by proper inspection and testing prior to installation.

Conglom Kitchen & Bath warrants this product to be free from defects in materials or workmanship for five (5) years from the date of purchase. Proof of purchase (original sales receipt) from the original consumer purchaser must be made available to Conglom Kitchen & Bath for all warranty claims.

This warranty is non-transferable and shall be voided if the unit is removed from its initial installation or if it is not installed following the manufacturer's instructions. It does not apply in the event of product damage due to the use of other than genuine Conglom Kitchen & Bath replacement parts, (Replacement parts may be obtained by e-mail at [customer.service@conglomkb.com](mailto:customer.service@conglomkb.com) or by calling 1-877-333-0098 between 8:30 am - 5:00 pm EST) installation error, abuse, misuse or improper care and maintenance (whether performed by a plumber, contractor, service provider or member of the purchaser's household). The warranty excludes damage due to aggressive air or water conditions, harsh or abrasive cleaners and/or materials.

Under no circumstance shall we be held liable for personal injury or property damage resulting from improper installation or use of this product. We will not be held liable for inconvenience caused by loss of use of this product, costs incurred for labour or materials, removal and installation of replacement units, or any other incidental or consequential damages. Costs relating to obtaining access for repair or replacement are the responsibility of the user.

Our obligation shall be limited to the repair or replacement of a unit (at our discretion) that may prove, by our sole examination, to be defective under normal use and service during the warranty period.

Any failure of this product that is not traceable to a defect in material or workmanship is not covered by this warranty. These non-warrantable items include, but are not limited to:

- Improper installation not in accordance with manufacturer's instructions.
- Dents and/or scratches incurred during shipping, handling, or installation.
- Change in colour or finish due to chemical usage.
- Damage caused by failure to follow care and cleaning guidelines, including damage caused by the use of abrasive cleaners.
- Alterations made to the unit by the purchaser or installer.
- Damage caused by accidental impact, fire, flood, freezing, and normal wear.
- Bends and warping caused by forced connections, over-tightened fittings, and inadequate support during installation.

This warranty does not extend to commercial and institutional installation or use.

## WARRANTY CLAIM PROCEDURE

If a claimable defect occurs or replacement parts are needed, please contact our customer service team at [customer.service@conglomkb.com](mailto:customer.service@conglomkb.com) or 1-877-333-0098 (8:30 am - 5 pm, EST, Monday - Friday).

Before you make your call, please ensure that you have:

- Model number or description.
- Proof of sale.
- Details regarding the defect and/or part number.
- Name(s) and address(es) of the owner and/or installer.

## Pre-Installation

Inspect your unit before proceeding. Check the surface for any flaws or damage, including dents, bends, bumps, or scuff marks. If any damage is noticed, do not proceed with installation. Please return the unit to place of purchase for an exchange. If there are any missing parts, please contact the manufacturer for replacements.

### TOOLS/MATERIALS REQUIRED (NOT SUPPLIED)

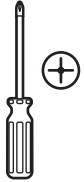

Phillips screwdriver



Utility knife

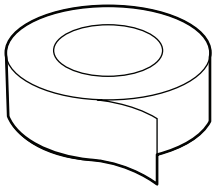

Tape

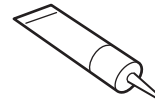

Silicone sealant

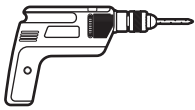

Electric drill



Level



Safety gloves



Safety glasses

### PARTS REQUIRED (NOT SUPPLIED)

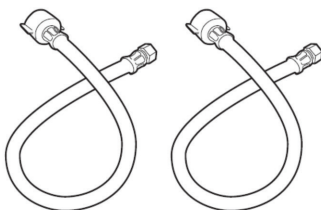

Supply lines (2)

# Pre-Installation (continued)

## PACKAGE CONTENTS

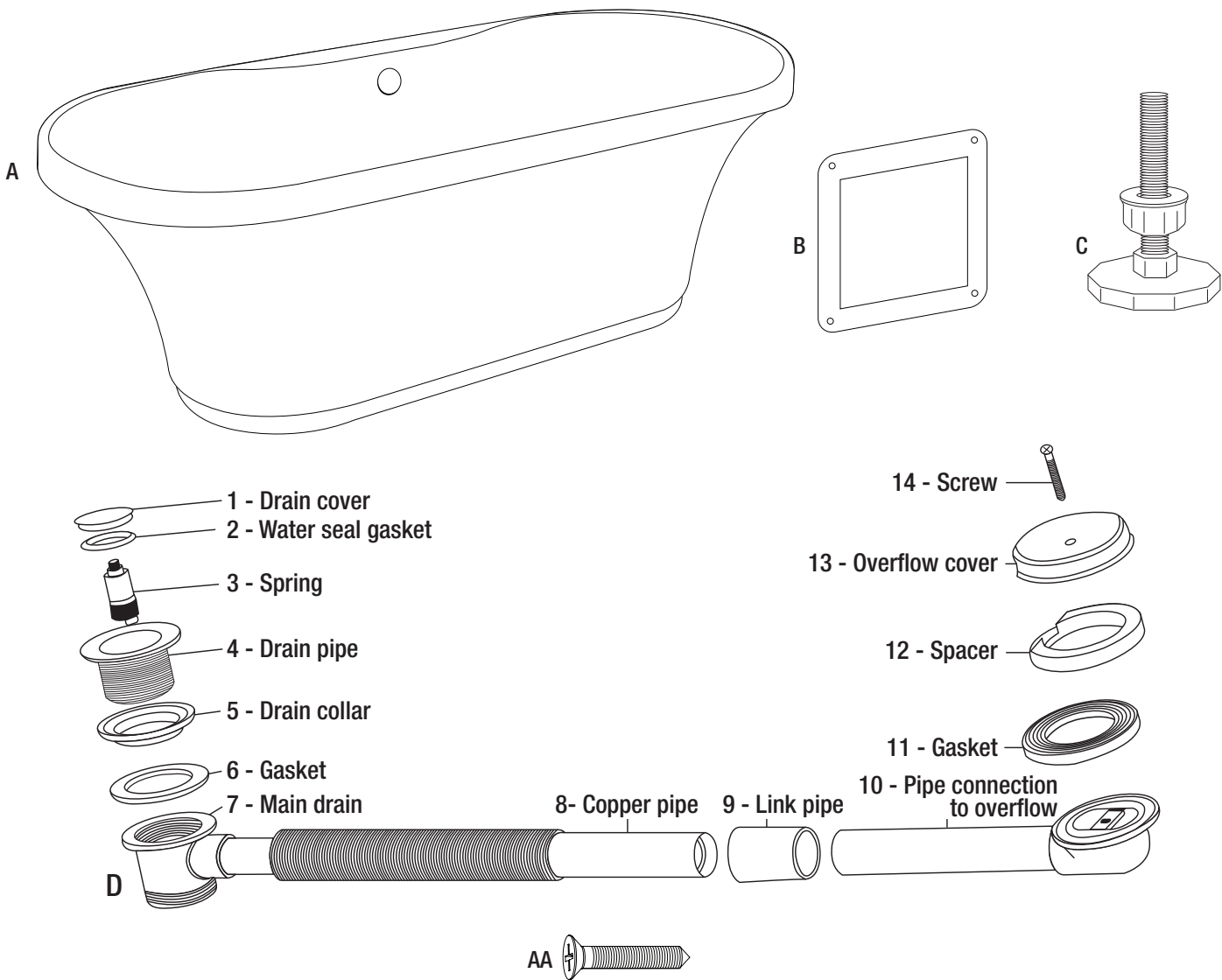

Part	Description	Quantity
A	Acrylic tub	1
B	Access door	1
C	Leveling legs	4
AA	Access door screws	4

Part	Description	Quantity
D	Overflow drain kit - Including:	1
1 - Drain cover	7 - Main drain	13 - Overflow cover
2 - Water seal gasket	8 - Copper pipe	14 - Screw
3 - Spring	9 - Link pipe	
4 - Drain pipe	10 - Pipe connection to overflow	
5 - Drain collar	11 - Gasket	
6 - Gasket	12 - Spacer	

## INSTALLING THE LEVELING LEGS

### **NOTE:**

*A thorough inspection must be made at the time of pick up or delivery. If the unit is damaged, do not install. The installation of this tub requires 2 people.*

- Carefully unpack the tub and contents from the packaging.
- Inspect all areas of the tub and parts to ensure there is no damage. If you discover any damage, do not install this unit and contact customer service.
- Place a blanket on the floor to protect the finish of the tub.
- Place the tub upside down on the blanket, see Fig. 1.

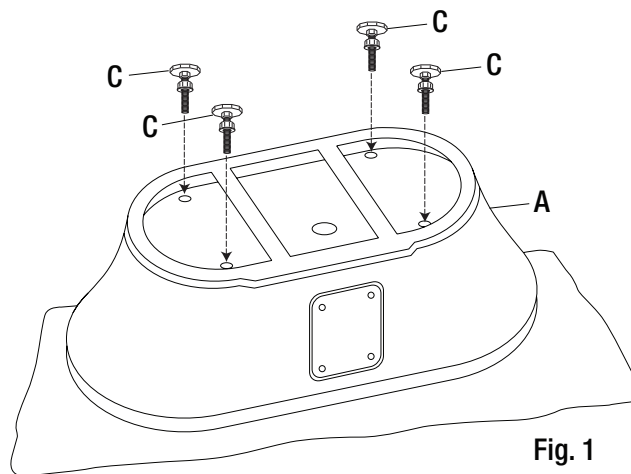

- Install the leveling legs with nuts and washers as shown, and ensure they rise 1.27 cm (0.5 in) outside the skirt bottom. See Fig. 2.

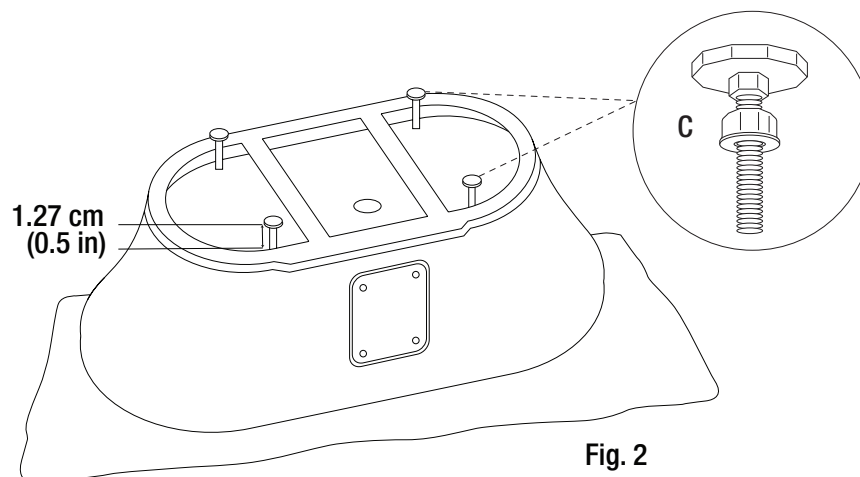

## Installation (continued)

### INSTALLING THE DRAIN/OVERFLOW

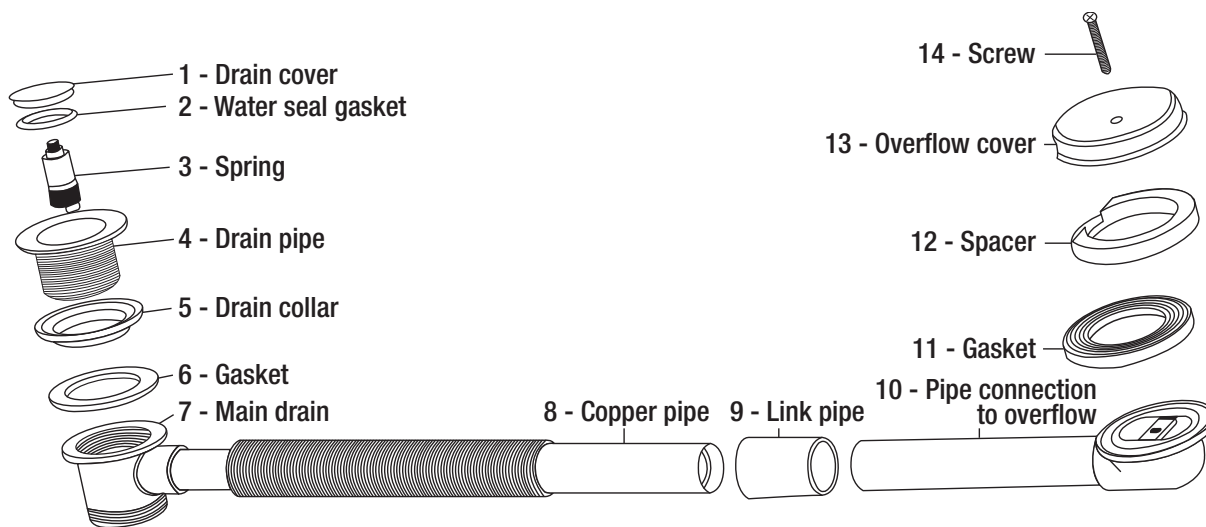

- Install the main drain/overflow (7) assembly onto the floor drain. See Fig. 3.

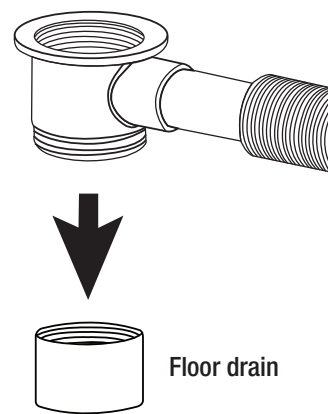

Fig. 3

- Carefully right the tub and move into its final position. Using a non-permanent marker, trace the lower perimeter of the tub below the access panel area, see Fig. 4.

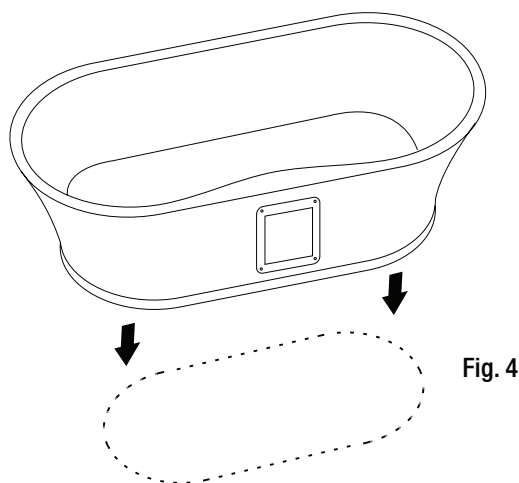

Fig. 4

## Installation (continued)

- Check that the unit is level by placing a carpenter's level across the width of the tub, and along the deck area to check in the other direction. Adjust the leveling legs as required until the tub is level and as close to the floor as possible. Repeat this step as necessary to ensure the tub is level for proper drainage. Once satisfied, tighten the lock nuts on all four feet.
- Gently bend the copper pipe (8) and feed it between the inner walls of the tub. Use the opening through the access door (B) to position the copper pipe (8).
- Assemble the overflow (see Fig. 5), ensuring the gasket (11) is inside the tub, and the spacer (12) is on the outer wall of the tub. Tighten the screw (14).

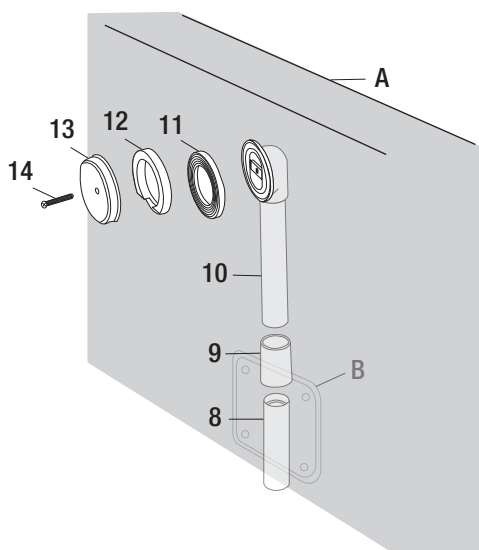

Fig. 5

- Place the supplied gasket (6) between the drain (7) and the bottom of the tub (A). Apply sealant around the tub drain (7) opening as well as inside the tub opening to seal the area. Place the drain collar (5) into the tub drain opening (7) and wipe away any excess sealant. Screw the drain cover through the collar (5) and into the main drain (7). Insert the drain plug (1, 2 & 3) into the drain pipe (4). See Fig. 6.

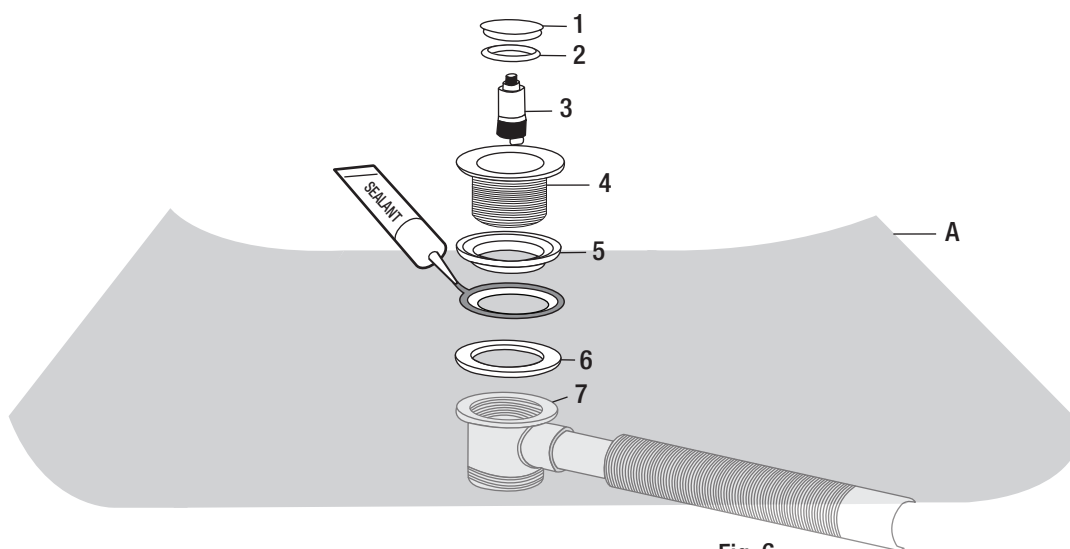

Fig. 6



## Installation (continued)

- Using masking tape, cover the area of the deck where you are choosing to install the faucets. Using extreme care, mark and double check the hole centers as per the faucet manufacturers instructions. Also verify your chosen location will not interfere with the overflow positioned underneath. Drill the required holes through the deck of the bath, using appropriate sized hole saws. Remove the masking tape upon completion, see Fig. 7.
- Attach the hot and cold water supply lines (not supplied).
- Test the entire system for any leakage by filling the tub with water, and then draining it. Once no leaks are detected, install the access panel (B) cover using the screws provided (AA).

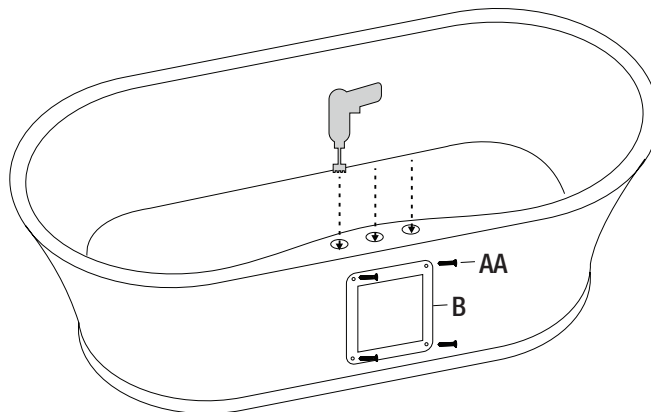

Fig. 7

## Care and Cleaning

### BATHTUB

Your bathtub is manufactured using top quality cast acrylic and is designed for years of comfort and enjoyment. To maintain the smooth, high gloss surface of your bathtub, follow these tips:

#### Do:

- Use common (non-abrasive) household cleaners or a mild liquid dish soap. Rinse well and dry with a clean cloth.
- Remove dust and dry dirt with a soft, damp cloth.
- Clean grease, oil, paint and ink stains with isopropyl (rubbing alcohol). Immediately rinse with water after removal of stain.

#### Do Not:

- Do not allow your acrylic surface to come into contact with products such as acetone (nail polish remover), nail polish, dry cleaning solution, lacquer thinners, gasoline, pine oil, etc.
- Use caution when handling sharp instruments that might fall and scratch the surface.

## Service Parts

If you are missing parts or if you require replacement parts, please contact our customer service team at [customer.service@conglomkb.com](mailto:customer.service@conglomkb.com) or 1-877-333-0098, 8:30 am - 5 pm, EST Monday-Friday. Identify the required part(s) and have the part number(s) ready.

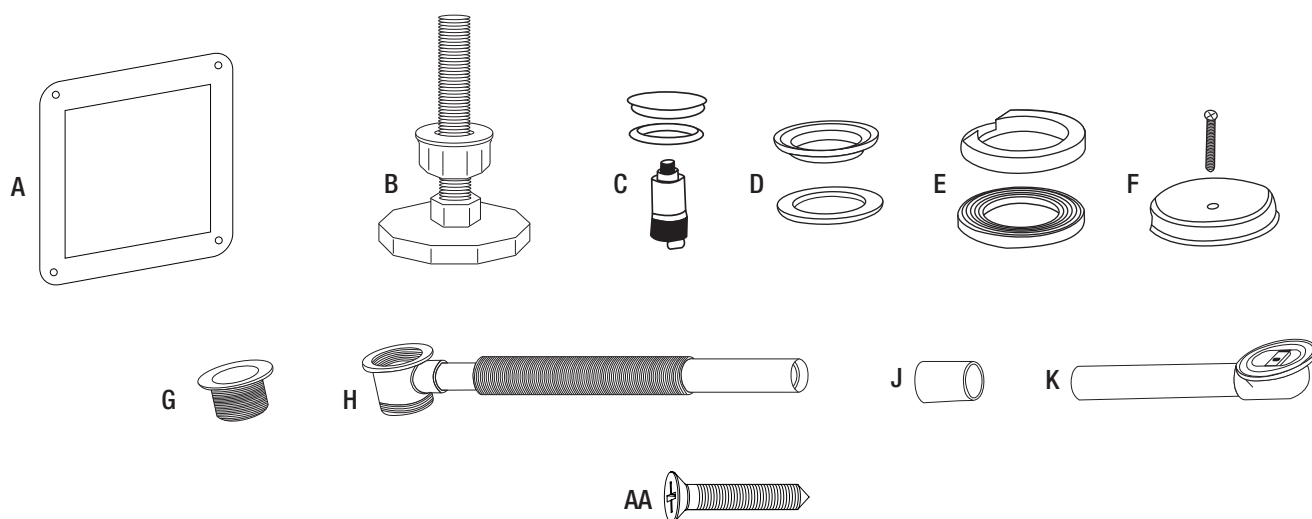

Part	Description	Code	Quantity
A	Access door	QHB127	1
B	Leveling legs	QHB129	4
C	Drain cover, water seal gasket & spring	QHB130	1
D	Drain collar & gasket	QHB131	1
E	Spacer & gasket	QHB132	1
F	Screw & overflow cover	QHB133	1
G	Drain pipe	QHB134	1
H	Main drain & copper pipe	QHB135	1
J	Link pipe	QHB136	1
K	Pipe connection to overflow	QHB137	1
AA	Access door screws	QHB128	4

Imported by:



St-Laurent, Québec, H4S 2C3  
1-877-333-0098  
[customer.service@conglomkb.com](mailto:customer.service@conglomkb.com)  
[www.conglomkb.com](http://www.conglomkb.com)

Made in China

