

Aria

QBVS110L

ULTRA QUIET HIGH AIRFLOW BATHROOM EXHAUST FAN WITH LIGHT

VENTILATEUR D'ÉVACUATION ULTRA SILENCIEUX ET HAUT DÉBIT AVEC ÉCLAIRAGE DE SALLE DE BAIN

VENTILADOR DE EXTRACCIÓN ULTRASILENCIOSO Y ALTO FLUJO DE AIRE CON LUZ PARA BAÑO



OWNER'S MANUAL
MANUEL DE L'UTILISATEUR
MANUAL DEL USARIO

REV.20200113

PLEASE READ AND SAVE THESE INSTRUCTIONS • INSTALLER: PLEASE LEAVE THIS GUIDE WITH THE HOME OWNER.

LISEZ ET CONSERVEZ CES INSTRUCTIONS • INSTALLATEUR: LAISSEZ CE GUIDE AU PROPRIÉTAIRE.

LEA Y GUARDE ESTAS INSTRUCCIONES • INSTALADOR: ENTREGUE ESTA GUÍA AL PROPIETARIO DE LA VIVIENDA.

Table of Contents

Safety Information 2

Warranty

 One Year Limited Warranty..... 3

 Warranty Claim Procedure..... 3

Pre-Installation

 Tools/Materials Required..... 4

 Package Contents 5

 Typical Installation..... 6

Installation 7

Operation..... 13

Care and Cleaning 13

Troubleshooting 14

Specifications

 Wiring Diagram 15

 External Diagram of Fan Unit..... 15

Service Parts..... 16

MANUEL DE L'UTILISATEUR 17

MANUAL DEL USARIO 32

Safety Information



WARNING:

WARNING – TO REDUCE THE RISK OF FIRE, ELECTRIC SHOCK, OR INJURY TO PERSONS, OBSERVE THE FOLLOWING:

1. Use this unit only in the manner intended by the manufacturer. If you have questions, contact the manufacturer.
2. Before servicing or cleaning unit, switch power off at service panel and lock the service disconnecting means to prevent power from being switched on accidentally. When the service disconnecting means cannot be locked, securely fasten a prominent warning device, such as a tag, to the service panel.
3. Installation work and electrical wiring must be done by a qualified person(s) in accordance with all applicable codes and standards, including fire-rated construction codes and standards.
4. Sufficient air is needed for proper combustion and exhausting of gases through the flue (chimney) of fuel burning equipment to prevent back drafting. Follow the heating equipment manufacturer's guideline and safety standards such as those published by the National Fire Protection Association (NFPA), and the American Society for Heating, Refrigeration and Air Conditioning Engineers (ASHRAE), and the local code authorities.
5. When cutting or drilling into wall or ceiling, do not damage electrical wiring and other hidden utilities.
6. Ducted fans must always be vented to the outdoors.
7. If this unit is to be installed over a tub or shower, it must be marked as appropriate for the application and be connected to a GFCI (Ground Fault Circuit Interrupter) – protected branch circuit.
8. This unit must be grounded.
9. Always unplug or disconnect the appliance from the power supply before servicing.
10. To reduce the risk of fire or electric shock, do not use this fan with any solid-state speed control device.
11. Do not install ventilation fan in a ceiling thermally insulated to a value greater than R40.
12. Use an ON/OFF switch to operate this ventilation fan. Use of speed controls may damage the motor.
13. If using a fluorescent light bulb, do not use dimmer switch to control light.
14. DO NOT INSTALL IN A WALL.



WARNING: The unit has sharp edges. Always wear safety gloves during installation, cleaning, or servicing.



CAUTION!

For general ventilating use only. Do not use to exhaust hazardous or explosive materials and vapors.

DO NOT install this unit onto an acoustic ceiling panel.

This product is designed for installation in ceilings up to a 12/12 pitch (45 degree angle). Duct connector must point up.

To avoid motor bearing damage and noisy, unbalanced impellers, keep drywall spray and construction dust away from power unit.

Please read specification label on product for further information and requirements.

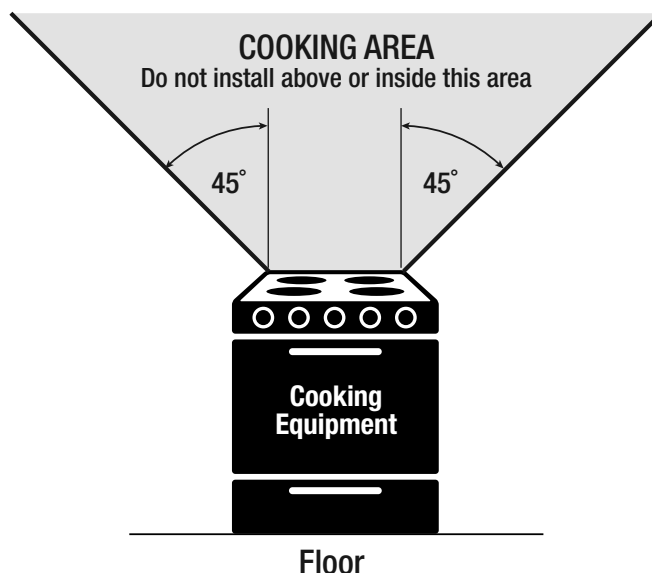

ONE YEAR LIMITED WARRANTY

A thorough inspection must be made before installation and any damage must be promptly reported. We will not be liable for failures or damage that could have been discovered or avoided by proper inspection and testing prior to installation.

Conglom Inc. warrants this product to be free from defects in materials or workmanship for one (1) year from the date of purchase. Proof of purchase (original sales receipt) from the original consumer purchaser must be made available to Conglom Inc. for all warranty claims.

This warranty is non-transferable and shall be voided if the unit is removed from its initial installation or if it is not installed following the manufacturer's instructions. It does not apply in the event of product damage due to the use of other than genuine Conglom Inc. replacement parts, (Replacement parts may be obtained by e-mail at cs@conglomkb.com or by calling 1-877-333-0098 between 8:30 am - 5:00 pm EST) installation error, abuse, misuse or improper care and maintenance (whether performed by a plumber, contractor, service provider or member of the purchaser's household). The warranty excludes damage due to aggressive air or water conditions, harsh or abrasive cleaners and/or materials.

Under no circumstance shall we be held liable for personal injury or property damage resulting from improper installation or use of this product. We will not be held liable for inconvenience caused by loss of use of this product, costs incurred for labour or materials, removal and installation of replacement units, or any other incidental or consequential damages. Costs relating to obtaining access for repair or replacement are the responsibility of the user.

Our obligation shall be limited to the repair or replacement of a unit (at our discretion) that may prove, by our sole examination, to be defective under normal use and service during the warranty period.

Any failure of this product that is not traceable to a defect in material or workmanship is not covered by this warranty. These non-warrantable items include, but are not limited to:

- Improper installation not in accordance with manufacturer's instructions.
- Dents and/or scratches incurred during shipping, handling, or installation.
- Change in colour or finish due to chemical usage.
- Damage caused by failure to follow care and cleaning guidelines, including damage caused by the use of abrasive cleaners.
- Alterations made to the unit by the purchaser or installer.
- Damage caused by accidental impact, fire, flood, freezing, and normal wear.
- Bends and warping caused by forced connections, over-tightened fittings, and inadequate support during installation.
- Any defects or damage to light bulbs.

This warranty does not extend to commercial and institutional installation or use.

WARRANTY CLAIM PROCEDURE

If a claimable defect occurs or replacement parts are needed, please contact our customer service team at cs@conglomkb.com or 1-877-333-0098 (Service available in English and French, Monday - Friday from 8:30 am - 5 pm, EST).

Before you make your call, please ensure that you have:

- Model number or description.
- Proof of sale.
- Details regarding the defect and/or part number.
- Name(s) and address(es) of the owner and/or installer.

Pre-Installation

TOOLS/MATERIALS REQUIRED (NOT SUPPLIED)

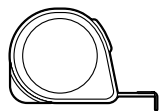

Measuring tape

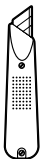

Utility knife

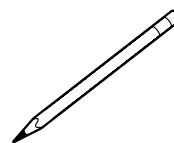

Pencil

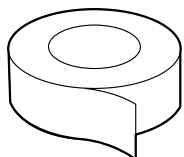

Aluminum foil tape

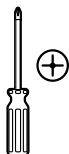

Phillips screwdriver



Needle nose pliers



Safety gloves



Electric drill



Safety goggles



Drywall saw



Pry bar

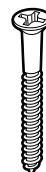

Wood screws



Respiratory mask

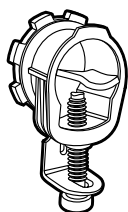

Cable clamp

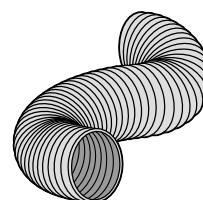

Flexible duct connector*

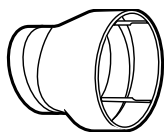

Duct adapter*

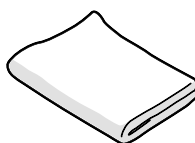

Cloth



Flathead screwdriver

*For best performance use 4" round metal ducting. Other ducting is acceptable but may impact performance. Use of existing metal ducting will require a short flexible duct connector. If your ducting is other than 4" in diameter, a duct adapter is required to make an air tight connection.

Pre-Installation (continued)

PACKAGE CONTENTS

Carefully check this product for damage and/or missing parts prior to installation. If there is any damage or if you are missing parts, do not proceed with the installation. Report damage and/or missing parts immediately to our customer service team at cs@conglomkb.com or 1-877-333-0098 (Service available in English and French, Monday - Friday from 8:30 am - 5:00 pm EST). Please do not dispose of packaging until you are satisfied with your new product.

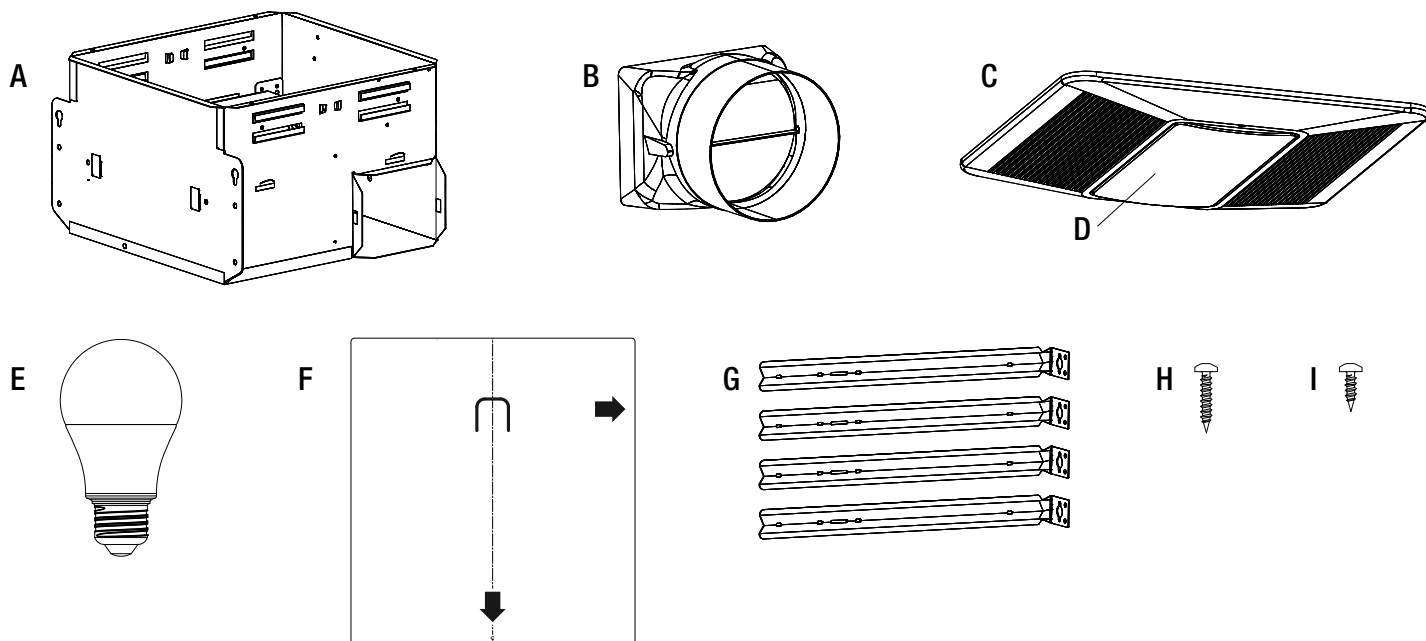

| Part | Description | Quantity |
|------|--------------------------------------|----------|
| A | Ventilation Fan | 1 |
| B | Damper | 1 |
| C | Grille | 1 |
| D | Light Cover (attached to grille) | 1 |
| E | Light Bulb | 1 |
| F | Installation Template and Dust Cover | 1 |
| G | Hanger Channels | 4 |
| H | Long Screws | 4 |
| I | Short Screws | 2 |

Pre-Installation (continued)

TYPICAL INSTALLATION

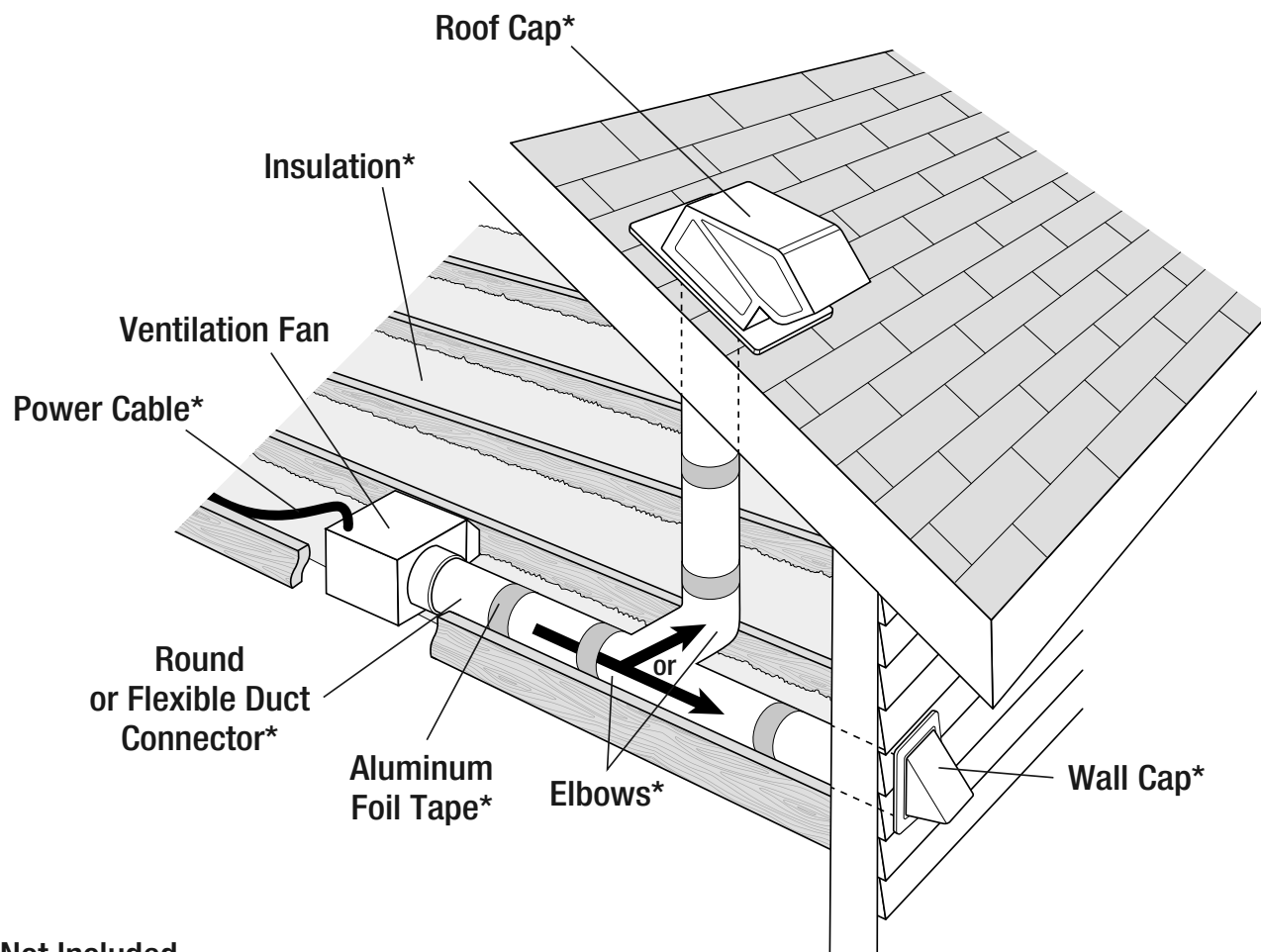

Fig.1

Installation

REPLACING AN EXISTING FAN



WARNING: Before removing the existing ventilation fan, switch power off at service panel and lock the service disconnecting means to prevent power from being switched on accidentally. When the service disconnecting means cannot be locked, securely fasten a prominent warning device, such as a tag, to the service panel.

NOTE:

For new installations, please see “Securing the Fan to The Ceiling Joists – Unfinished Ceilings” section.

- Ensure the existing fan opening is smaller than the supplied installation template so it can be enlarged to fit the new fan if required. Check to ensure the joist arrow indicated on the template is oriented correctly. It should be pointing towards the ceiling joist.
- Mark the center line of the existing fan opening as shown in figure 2.
- Align the provided installation template with the joist side and center line, then draw along the template perimeter. See figure 3.
- Using a utility knife, score the ceiling along the perimeter.

NOTE: It is recommended that you wear a respiratory mask when cutting the drywall and removing the old fan.

- Check to make sure the power to your existing fan has been switched off at the service panel.
- Cut the new opening in the ceiling using a drywall saw. Be careful not to damage the existing venting or electrical wiring. See figure 4.
- Disconnect existing ductwork and electrical wiring.
- Remove the old fan along with any installation hardware. Use a pry bar if necessary. Once your old fan has been removed, you are ready to install your new ventilation fan. See figure 5.



WARNING: Always wear safety goggles and gloves during installation to prevent personal injury.

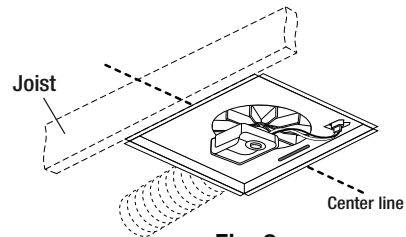

Fig. 2

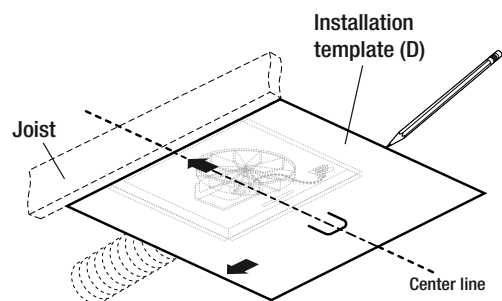

Fig. 3

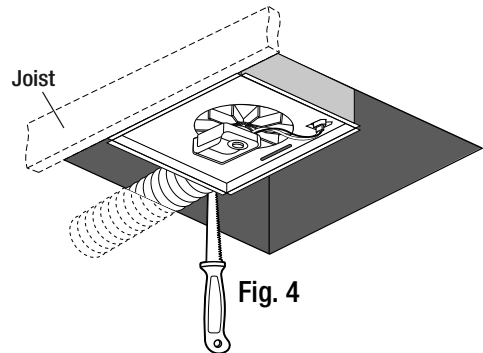

Fig. 4

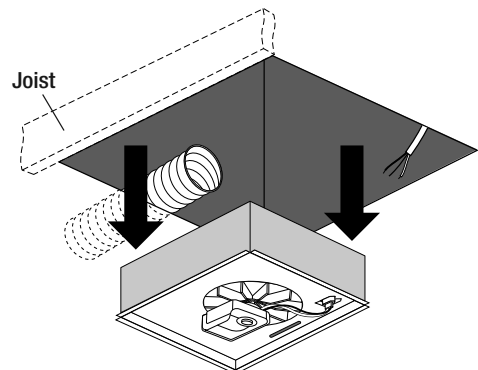

Fig. 5

Installation (continued)

PREPARING THE NEW FAN



WARNING: It is recommended that you wear safety gloves when handling the ventilation fan because it has sharp edges that could cause injury.

- Unplug the motor from the receptacle. See figure 6.
- Remove the screw securing the motor mounting assembly to the fan housing and take the assembly out by releasing tabs. See figure 7.
- Unscrew the screw securing the electrical wiring junction cover and slide the cover upwards to remove it. See figure 8.

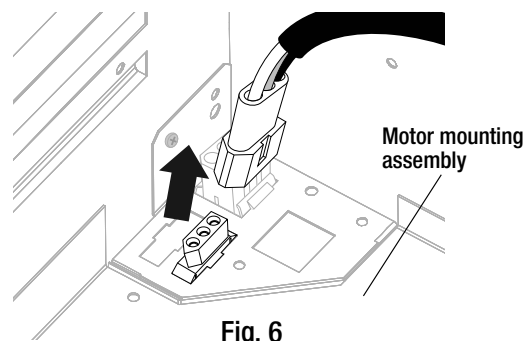

Fig. 6

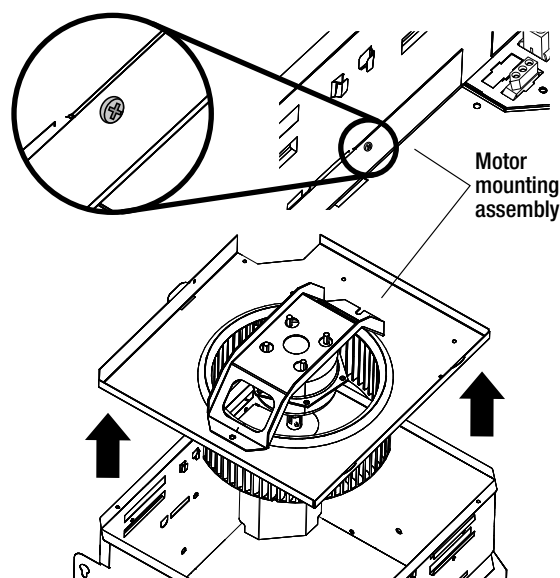

Fig. 7

CONNECTING THE ELECTRICAL WIRING

WIRING CONNECTION REQUIREMENTS

OBSERVE ALL GOVERNING CODES AND ORDINANCES

1. Electrical grounding is required for this ventilation fan. Check with qualified electrician if you are not sure whether the ventilation fan is properly grounded.
2. Failure to follow electrical requirements may result in a fire.
3. A fuse in the neutral or grounding circuit could result in electrical shock.
4. If the hot/cold water pipe is interrupted by plastic nonmetallic gaskets or other materials, DO NOT use for grounding.
5. DO NOT GROUND TO A GAS PIPE.
6. Save installation instructions for electrical inspector's use.
7. If codes permit and a separate ground wire is used, it is recommended that a qualified electrician determine if the ground path is adequate.
8. DO NOT use an extension cord or adapter plug with this appliance.
9. The ventilation fan must be connected with copper wire only.

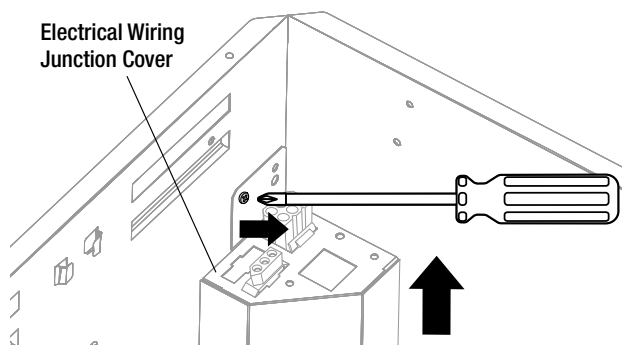

Fig. 8

Installation (continued)

10. The ventilation fan should be connected directly to the switch through flexible, armoured or nonmetallic sheathed copper cable. Allow some slack in the cable so the appliance can be moved if servicing is ever necessary.
11. A UL listed or CSA approved conduit connector must be provided at each end of the power supply cable.
12. Wire size must conform to all local codes and ordinances. The latest edition requirements of the National Electrical Code ANSI/NFPA 70, or the latest edition CSA Standards C22.1-94, Canadian Electrical Code Part 1 and C22.2 No. 0-M91.



WARNING – TO REDUCE THE RISK OF FIRE, ELECTRIC SHOCK, OR INJURY TO PERSONS, OBSERVE THE FOLLOWING: Installation work and electrical wiring must be done by qualified person(s) in accordance with all applicable codes and standards, including fire-rated construction.



DANGER: Risk of electrical shock. This ventilation fan must be properly grounded.



DANGER: Turn off the power circuit breaker or the power switch on the junction box before installing this unit. Touching circuitry inside the ventilation fan while it is energized will result in death or serious injury.



DANGER: All electrical wiring must be properly installed, insulated, and grounded. Improper insulation and grounding will result in deadly electrical shock.

IMPORTANT: It is the customer's responsibility to contact a qualified electrical installer and ensure that the electrical installation is adequate and complies with the National Electrical Code, or CSA standards, as well as all local codes and ordinances.

- Install a cable clamp (not supplied) to the wiring hole of the fan housing in either of the two available locations as shown in figure 9.
- Feed the electrical supply cable through the cable clamp. See figure 9.
- Use UL approved connectors to connect the fan wires to your electrical supply cable as shown in figure 10.
- Tighten the cable clamp to secure the electrical supply cable.
- Reinstall the electrical wiring junction cover to the fan housing ensuring all wiring connections are fully enclosed. See figure 11.

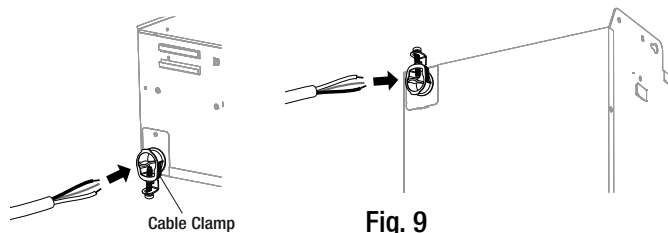
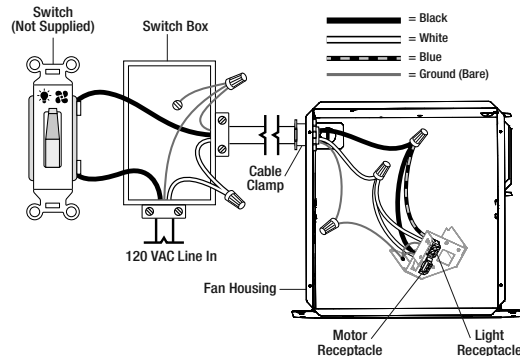
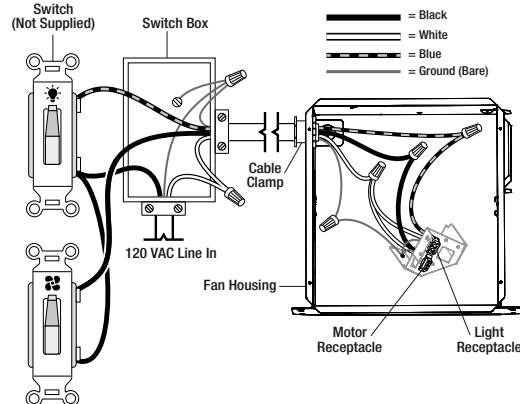

Fig. 9

One Single Pole Switch (Controls both fan and light together)



Two Single Pole Switches (Control fan and light independently)



Double Single Pole Switch (Control fan and light independently)

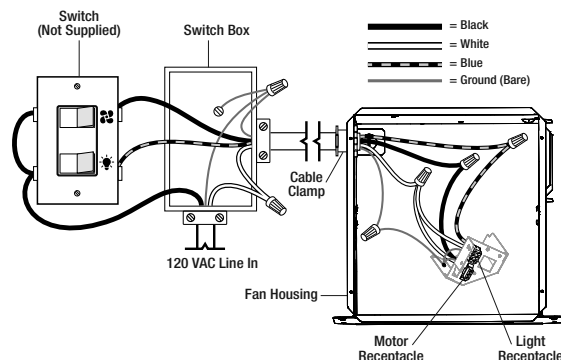

Fig. 10

Installation (continued)

INSTALLING THE DAMPER TO THE FAN HOUSING

- If damper flap is not attached, fit into place. Ensure the flap is oriented correctly. See figure 12.
- Attach the damper to the fan housing and make sure all tabs of housing are enclosed. See figure 13.

CONNECTING THE DUCT

NOTE: Using flexible duct connector is recommended for the quietest possible installation. If rigid duct is to be used, having a 1-3 feet section of flexible ducting will allow for a quiet installation.

- Pull existing ducting through the ceiling opening. If existing ducting is metal you will require a short flexible duct connector. Rigid duct may need to be cut for proper installation.
- Position the fan housing assembly properly and secure existing ducting to the fan's damper.
- If using a flexible duct connector or duct adapter, use aluminum foil tape at each end to secure the connector or adapter to the existing ducting and to the fan's damper. See figure 14.
- Ensure that the fan's damper is unobstructed and free to swivel freely.

If you are replacing an existing fan then proceed to "Securing the Fan to The Ceiling Joists – Finished Ceilings" section.

If this is a new installation and your ceiling is unfinished, proceed to "Securing the Fan to The Ceiling Joists – Unfinished Ceilings" section.

SECURING THE FAN TO THE CEILING JOIST - FINISHED CEILINGS



DANGER: Turn off the power circuit breaker or the power switch on the junction box before installing this unit. Touching circuitry inside the ventilation fan while it is energized will result in death or serious injury.

NOTE: Ensure your fan is properly connected to the duct work and electrical supply cable (not powered) before proceeding.

- With the motor mounting assembly removed, gently insert the fan housing into the fan opening in the ceiling. Position housing such that the bottom edges are aligned with the ceiling surface.
- Secure the fan housing to the ceiling joist with screws. Ensure the housing is fastened securely. Reinstall the motor mounting assembly with tabs and screw. Plug motor into the receptacle. See figure 15.

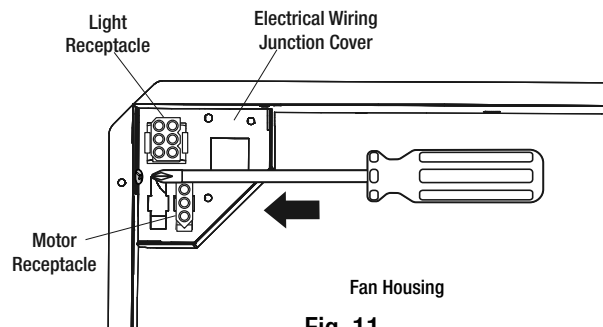

Fig. 11

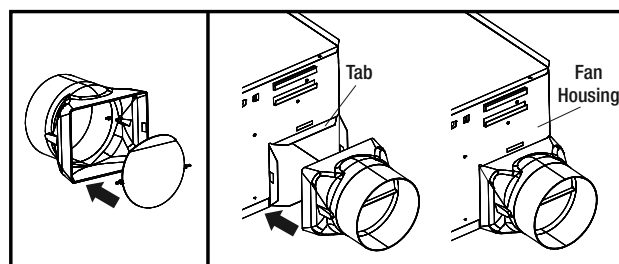

Fig. 12

Fig. 13

If your ducting is other than 4" in diameter, a duct adapter is required (not supplied) to make an air tight connection.

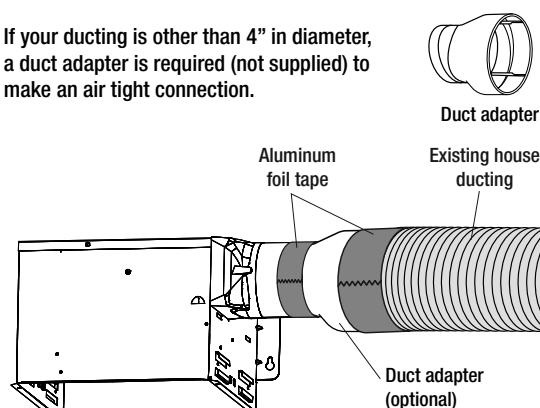

Fig. 14

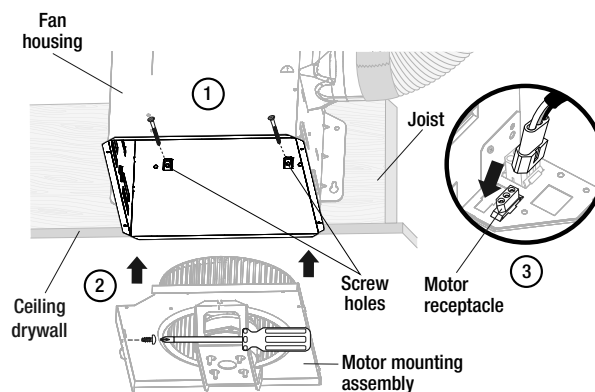

Fig. 15

Installation (continued)

SECURING THE FAN TO THE CEILING JOIST - UNFINISHED CEILINGS



DANGER: Turn off the power circuit breaker or the power switch on the junction box before installing this unit. Touching circuitry inside the ventilation fan while it is energized will result in death or serious injury.

NOTE: Ensure your fan is properly connected to the duct work and electrical supply cable (not powered) before proceeding.

- Secure the ventilation fan to the ceiling joist in a desired location. This fan offers several convenient ways to secure the housing to your ceiling joists (both conventional and I-joist). Choose the method most appropriate to your ceiling construction as shown in figures 16 and 17.
- Reinstall motor mounting assembly. Plug the motor into the receptacle. See figure 18.
- Power the fan to make sure everything is in proper working order.
- Once you are satisfied with your installation, protect the bath fan motor from construction dust and debris with the supplied dust cover (D) until construction is completed. See figure 19. Do not install the dust cover in finished construction. Do not operate the fan with the dust cover in place as it will damage the motor.

Joist Profiles

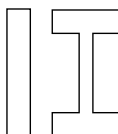

NOTE: Duct and electrical connections not shown for clarity.

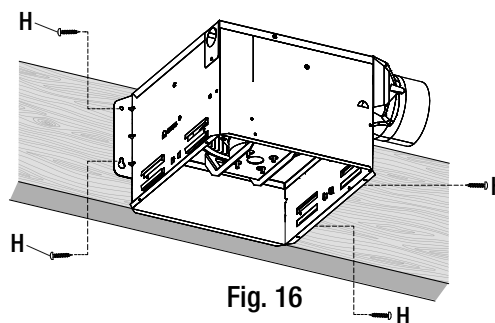

Fig. 16

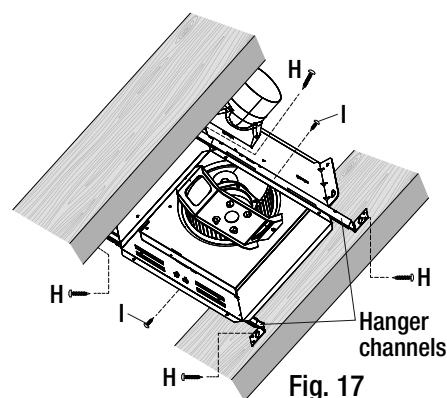

Fig. 17

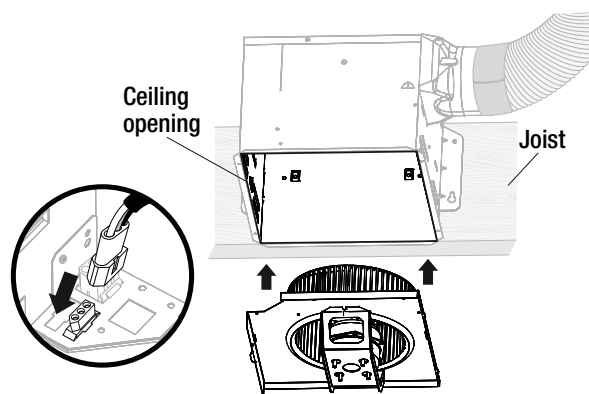

Fig. 18

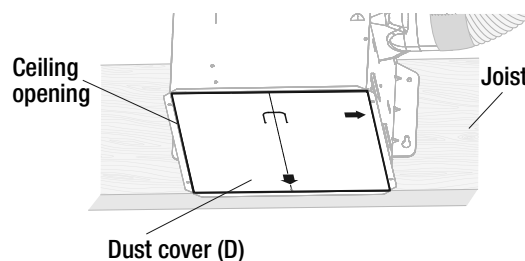

Fig. 19

Installation (continued)

INSTALLING THE LIGHT BULB



CAUTION: To reduce the risk of electric shock, disconnect the electrical supply circuit to the fan before installing light kit.



WARNING: If using fluorescent light bulb, do not use dimmer switch to control light.

- With a piece of cloth in between to avoid scratching the cover, use a flathead screwdriver to pry the light cover out of the grille. See figure 20.
- Screw light bulb into place. See figure 21.
- Properly plug light into receptacle. See figure 22.
- Test to ensure light works and reinstall light cover to grille.

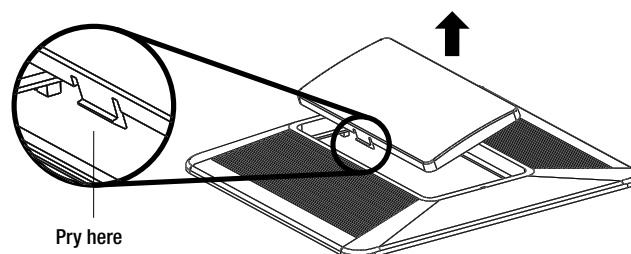

Fig. 20

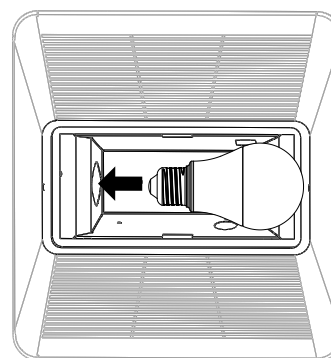

Fig. 21

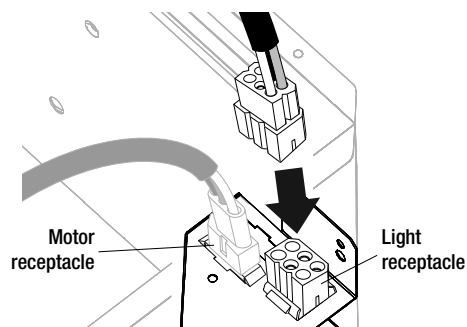

Fig. 22

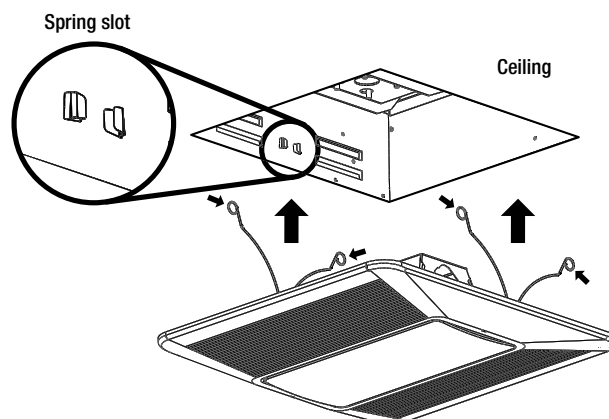

Fig. 23

Operation

TURNING ON/OFF THE UNIT

- This ventilation fan with light can be operated with an external switch.
- To operate the ventilation fan and light at the same time, use a single pole (on/off) switch.
- To operate fan and light separately, use two single-pole switches or a double single-pole switch.
- If using a fluorescent light bulb, do not use dimmer switch to control light.



WARNING: To Reduce The Risk Of Fire Or Electric Shock, Do Not Use This Fan With Any Solid-State Speed Control Device.

Care and Cleaning



WARNING: Failure to maintain basic standards of care and cleaning of the ventilation fan increases the risk of fire, electric shock, or injury to persons. Before servicing or cleaning unit, switch power off at service panel and lock the service disconnecting means to prevent power from being switched on accidentally. When the service disconnecting means cannot be locked, securely fasten a prominent warning device, such as a tag, to the service panel.



WARNING: Ensure light bulb is cool enough to touch before replacing it.

The ventilation fan should be cleaned regularly (internally and externally) to preserve its appearance and performance. Remove grille, light cover and light bulb to clean interior of ventilation fan.

Do:

- Use a dusting brush attachment to gently vacuum the exterior and interior of the ventilation fan to remove dust and debris.

Do Not:

- Do not let plaster dust or any other construction residue enter the fan. During construction or renovation, cover the fan.
- Combustible products used for cleaning such as acetone, alcohol, ether, or benzol are highly explosive and should never be used close to the fan.

Troubleshooting



DANGER: Turn off the power circuit breaker or the power switch on the junction box before performing maintenance. Touching circuitry inside the ventilation fan while it is energized may result in serious injury or death.



WARNING: Failure to maintain basic standards of care and cleaning of the ventilation fan increases the risk of fire, electric shock, or injury to persons. Before servicing or cleaning unit, switch power off at service panel and lock the service disconnecting means to prevent power from being switched on accidentally. When the service disconnecting means cannot be locked, securely fasten a prominent warning device, such as a tag, to the service panel.

| Problem | Solution |
|---|--|
| The fan does not operate. | <ul style="list-style-type: none"> - Check that the power supply cable and all electrical wiring are properly connected. - Check that the fan blade is not obstructed. - Check that the power is turned on at the junction box or circuit breaker. |
| The fan vibrates when the fan is operating. | <ul style="list-style-type: none"> - Check that the fan has been secured properly. Tighten into position, if necessary. - Check that the motor is secured in place. If not, then tighten the motor in place. - Check that the fan is not damaged. If so, replace the fan. |
| The fan seems weak. | <ul style="list-style-type: none"> - Check that the duct size used is of appropriate size. The fan will not function efficiently with insufficient duct size. - Check that the duct is not clogged with debris and the tight mesh on the wall cap, if applicable, is not restricting air flow. - Check that the damper unit is opening properly. - Check that no birds or animals have nested in the duct. |
| The fan is not venting properly. | <ul style="list-style-type: none"> - Reduce the length of duct work and the number of elbows if necessary. Ensure that all joints are properly connected, sealed, and taped. - Check that the duct does not open against the wind. |
| The fan is making excessive noise. | <ul style="list-style-type: none"> - Check to make sure there is nothing blocking the fan blade. - The fan motor is permanently lubricated and does not need to be oiled or lubricated. If the motor bearings are making excessive or unusual noises they should be replaced. The fan blade should also be replaced at that time. - Check to make sure that the fan's damper can pivot freely and is not obstructed. - Check to make sure the damper in the wall or roof cap can pivot freely and is not obstructed. |
| The light does not work. | <ul style="list-style-type: none"> - Check that the light bulb has been properly installed. - Check that the power is turned on at the junction box or circuit breaker. - Check that the light bulb is not broken. Do this by installing a light bulb that you know is working. |

Specifications

| | |
|--|--|
| Model | QBVS110L |
| Air Delivery (CFM - Cubic Feet Per Minute) | 110 ± 10% |
| Lound Level (Sones) | 0.9 |
| Duct Size | 4" (10.16 cm) |
| Motor Power (W) | 30 |
| Voltage / Frenquency | 120 VAC / 60Hz |
| Light | 10W MAX |
| Housing Dimensions | 11 3/8" x 10 1/2" x 7 5/8" (28.9 cm x 26.7 cm x 19.4 cm) |
| Grille Dimensions | 13" x 13 3/4" (33 cm x 34.9 cm) |
| Net Weight (Kg) | 3.93 |

WIRING DIAGRAM

TO CONTROL FAN AND LIGHT TOGETHER

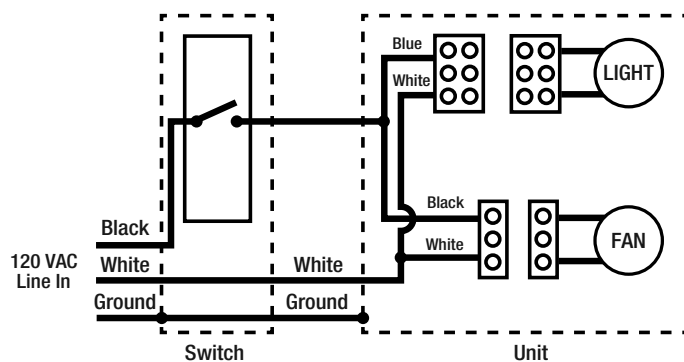

TO CONTROL FAN AND LIGHT INDEPENDENTLY

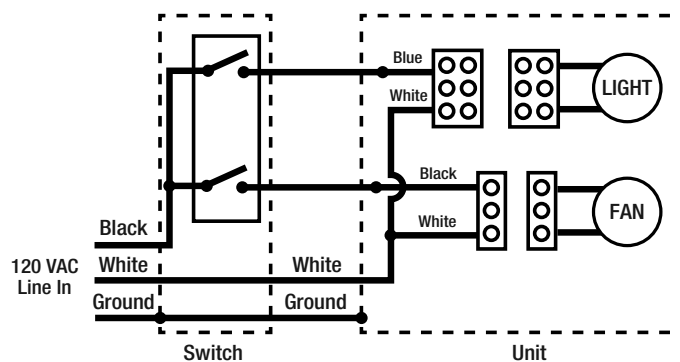

EXTERNAL DIAGRAM OF FAN UNIT

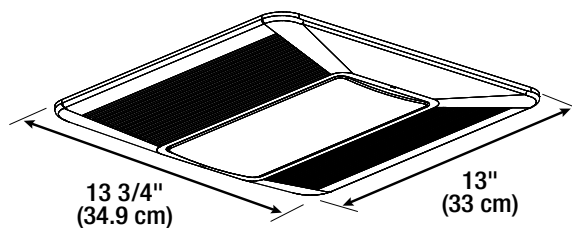
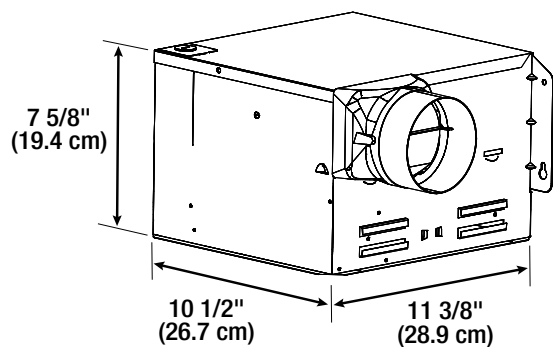

Service Parts

If you are missing parts or if you require replacement parts, please contact our customer service team at cs@conglomkb.com or 1-877-333-0098 (8:30 am – 5 pm, EST, Monday–Friday). Identify the required part(s) and have the part number(s) ready.

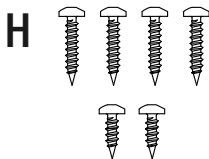
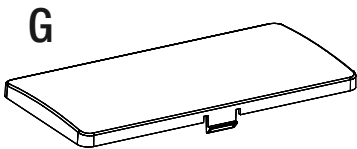
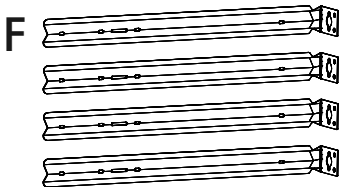
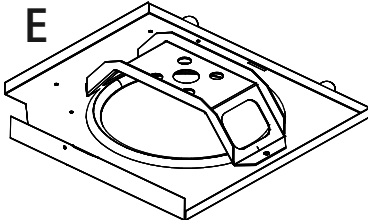
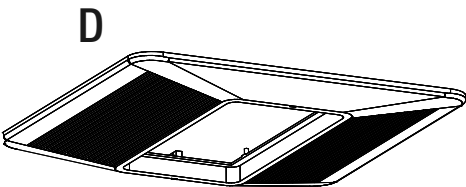
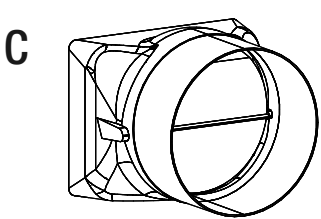
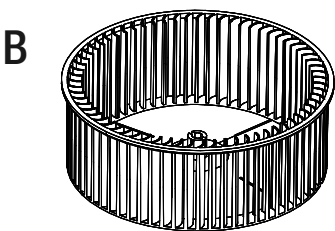
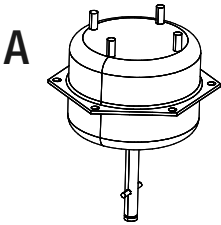

| Part | Description | Code | Quantity |
|------|--------------------|--------|----------|
| A | Motor | QHB183 | 1 |
| B | Fan Blade | QHB191 | 1 |
| C | Damper | QHB193 | 1 |
| D | Grille | QHB180 | 1 |
| E | Motor Bracket | QHB186 | 1 |
| F | Hanger Channel Set | QHB195 | 1 |
| G | Light Cover | QHB198 | 1 |
| H | Hardware Pack | QHB197 | 1 |

Imported by / Importé par / Importado por :

Conglom

St-Laurent, Québec, H4S 2C3

1-877-333-0098 | cs@conglomkb.com

(service available in English and French, Monday - Friday from 8:30 am - 5 pm EST)

(service disponible en anglais et français, du lundi au vendredi, 8h30 à 17h, H.N.E.)

(servicio disponible en inglés y francés, de lunes a viernes, de 8:30 am a 5:00 pm, hora del Este)

www.conglomkb.com